

Killarney 95 sq.m



ground floor



first floor

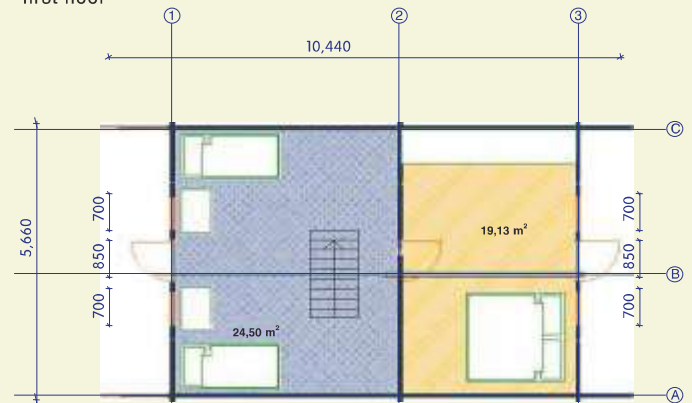

Two Storey Log Cabin 95 m²

6 x 9 m (5,85 x 8,75) - **IE10068030**

- Wall thickness 70 mm T&G;
- Roof cover -external - plywood, internal planed boards;
- Floors - 26 mm thickness;
- The corbel of the roof around the whole house;
- Double Glazed windows and door;
- Roof area - 110 sq.m;
- Stairs included;
- Double roof construction (for insulation, wich is extra);
- Windows can be switched for ventilation.

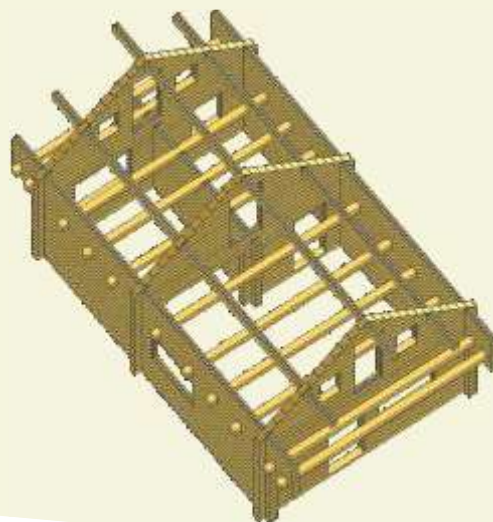

(70mm)